

Laurissilva Gallery

Funchal Aquarium

SOCIEDADE METROPOLITANA de DESENVOLVIMENTO, S.A., NIPC

Madeira Island, Portugal

PROJECT FACTS

scope	Exhibit Planning and Design
size	7000 Sq Meters
budget	\$29.8M
architect	Risco Project Consultants and Design, S.A.
completion	2008

The Madeira Archipelago, a part of Macaronesia, unite the Canary Islands, Azores, and Cape Verde Islands. It is a place of unique and unusual life forms. The new aquarium will take visitors on a tour down the volcanic islands' mountainside from the sub-tropical evergreen forests (a remnant of ancient forests that existed in Europe and North Africa before the last Ice Age) to the shore and undersea slopes that plunge nearly two miles to the abyssal plain.



Multi-language Graphic Panel

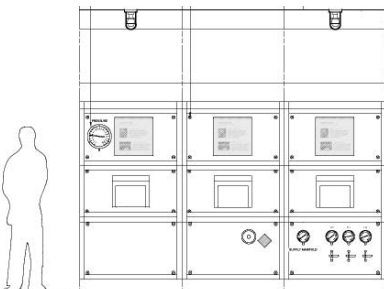

Submersible Interactive Exhibit

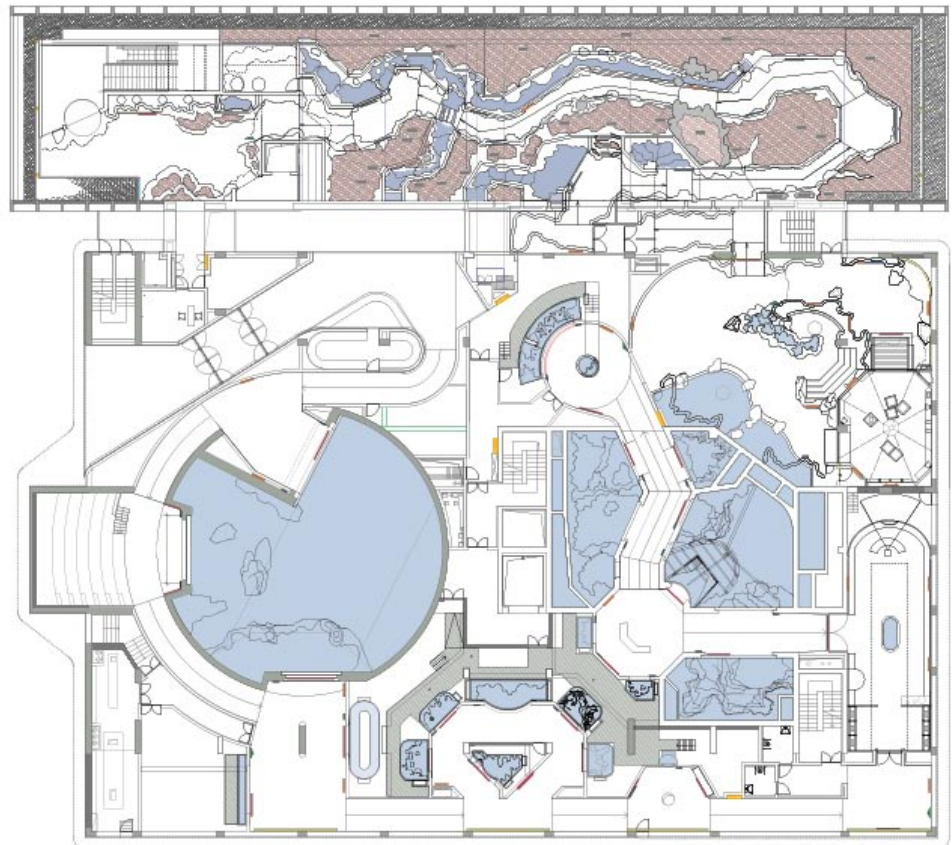

Plan View